



TL BASKET LEVELLING PROCEDURE

DOCNUMBER
Rev. 00
03/10/2023
Page 1 of 4

REVISIONS			RESPONSIBLE	
N.	DATE	DESCRIPTION	CREATED BY	CHECK/APPROVE
1	05/10/23	Original	Snehal Rana	

TL Basket Levelling Procedure

Step-by-Step Instructions to Calibrate the Bucket Levelling System

1. Start the Truck and Set Up the Boom

- Start the truck.
- Engage the PTO (Power Take-Off).
- Set up the truck to operate the boom.
- Move the boom and bucket out of the rest position into a safe position where the bucket can tilt downward safely.

2. Access the Levelling Transmitter

- Open the cover for the manual controls located at the **left rear jack leg**.
- Use the manual controls to **level the bucket down**.
- Remove the cover to access the levelling transmitter.



Manually tilt bucket, remove the 2 nylon bolts and remove this cover

3. Isolate Power to the Transmitter

- Remove the battery from the levelling system to **isolate power** to the transmitter.



4. Initial Calibration - Bucket Levelled

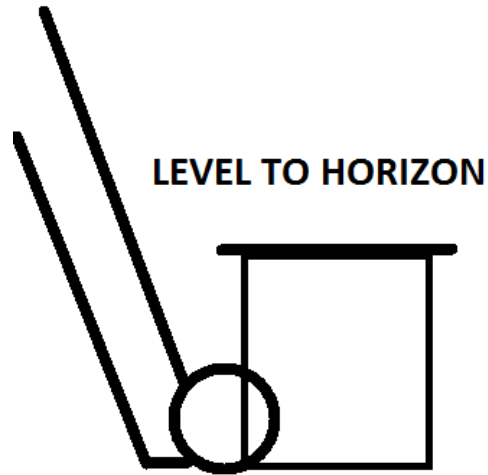

- Manually level the bucket again.
- **Reinstall the battery.**
- Push and **hold the calibration button** on the transmitter.

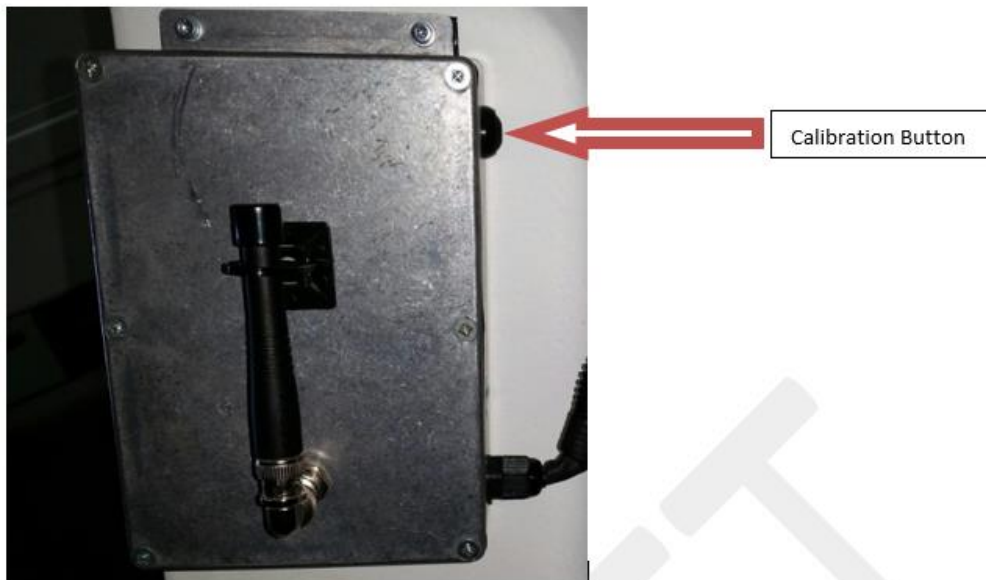

- Continue holding the button until you hear the **second beep** from the transmitter.
- After the second beep:
 - Remove the battery.
 - Release the calibration button.



5. Second Calibration - Bucket Tilted 90°

- Manually rotate the bucket down 90°.

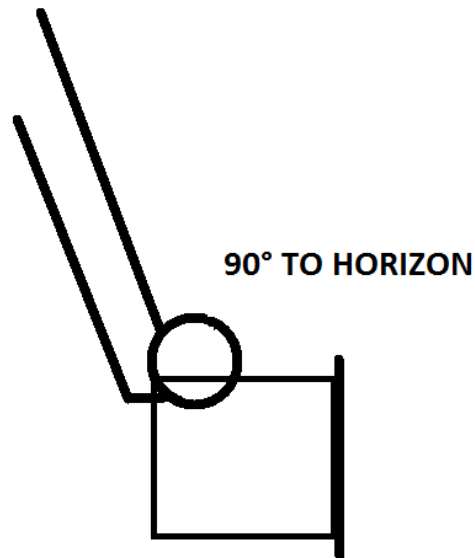

- Reinstall the battery.
- Push and hold the calibration button on the transmitter.

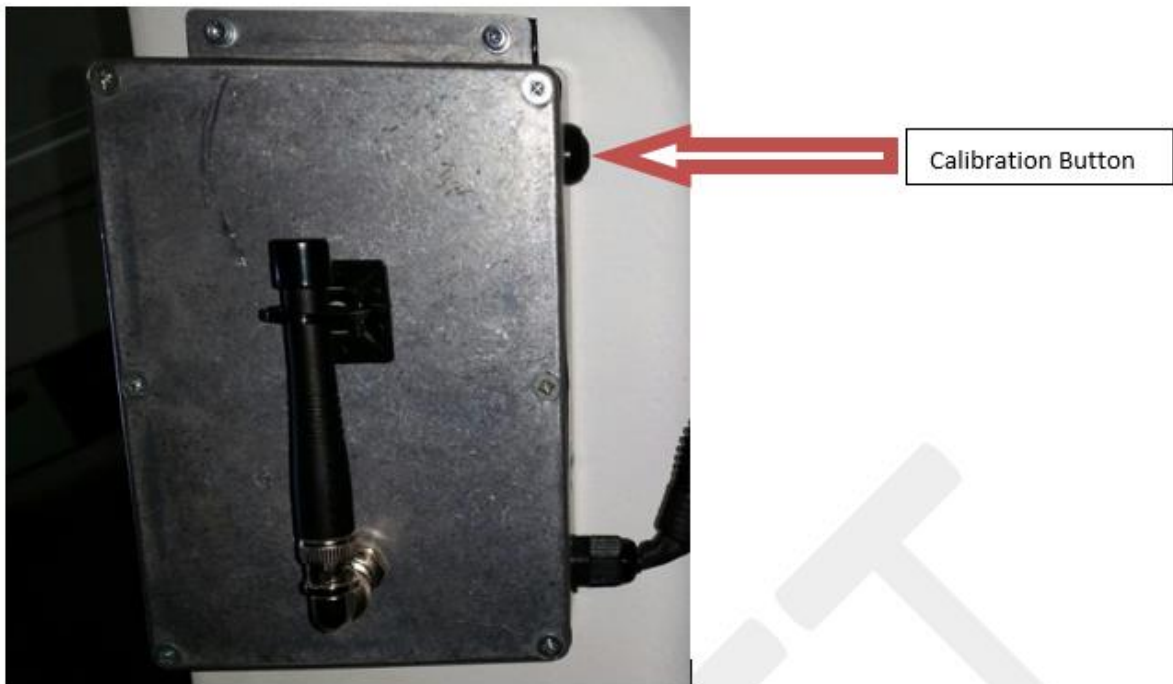



- Continue holding the button until you hear the **second beep**.
- After the second beep:
 - Remove the battery.
 - Release the calibration button.

6. Reinstall the Battery and Test

- Manually **level the bucket** again.
- Reinstall the battery into the levelling system.
- Close the cover for the manual controls.

7. Start the Observer Transmitter

- Turn on the **radio remotes**.
- Push and hold the **green start button** on the Observer transmitter.
- Release the button once the **truck alarm stops**.

8. Test the Operation

- Verify that the system operates correctly.
- If everything works as expected:
 - Rotate the bucket back into position.
 - Reinstall the **fibreglass cover**.
 - Manually level the bucket again and reset the battery.

Notes:

- Follow safety protocols while handling the boom and bucket.
- Ensure the truck is stable and all components are secure during operation.